

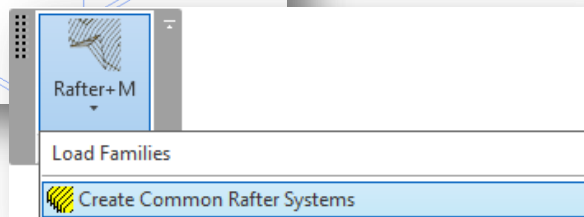

METAL FRAMING RAFTER+

Create Common Rafter Systems

Create Common Rafter Systems

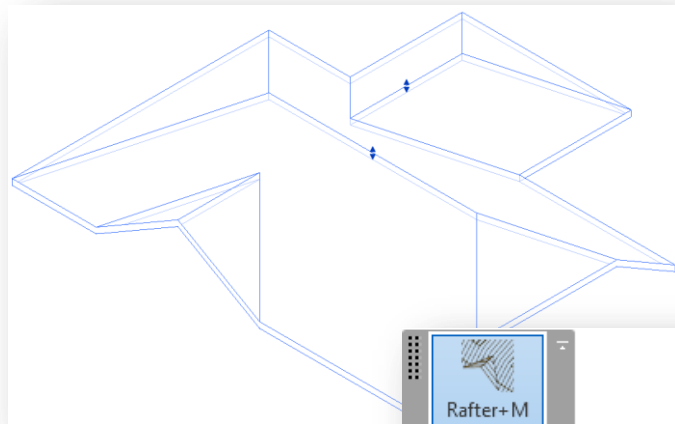
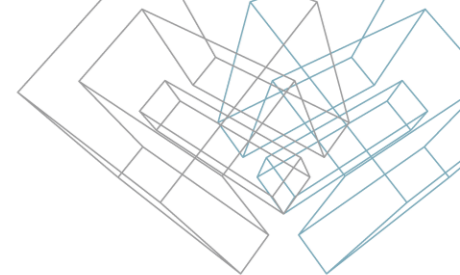

- Select roof
- Select the **Create common rafter systems** function from “Rafter+M” menu.

NOTE: Load families to your project before starting Create Common Rafter System command.

Configure Beams

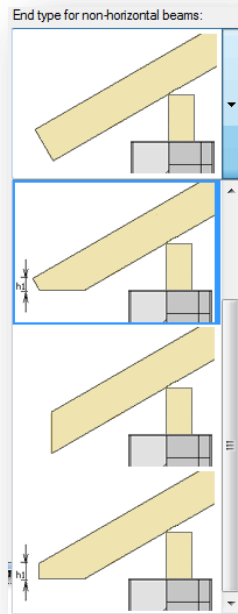
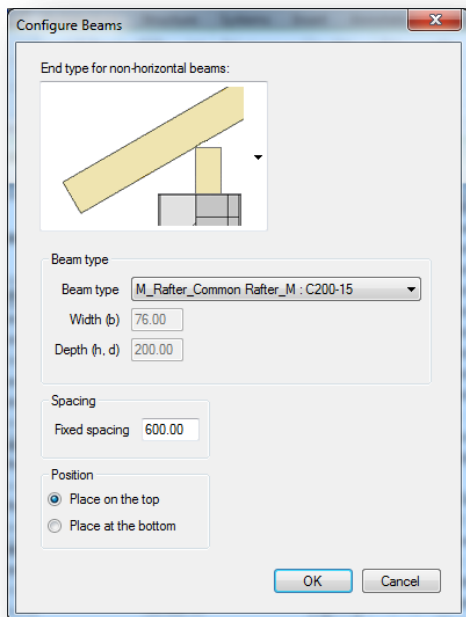
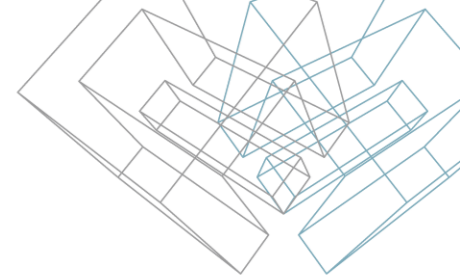

- Now you can choose End cut type of the rafter.
- Enter the End *cut height* dimension **h1** if required.
- Select framing family available in the project for Rafter beam.
- Enter the distance of Fixed Rafter spacing.
- Select position of rafter beam.

NOTE:

You can change all these parameters at any time.

Configure Beams

- Placed on the top

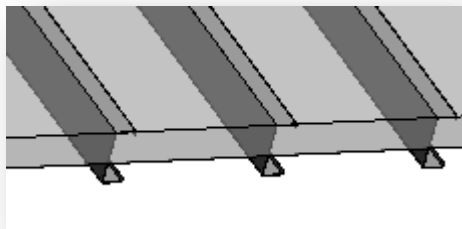

- Placed at the bottom

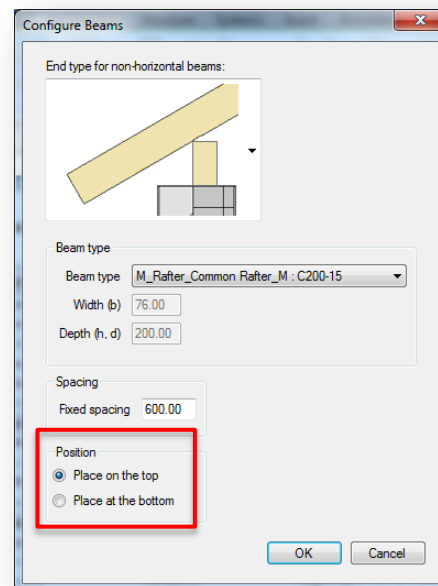
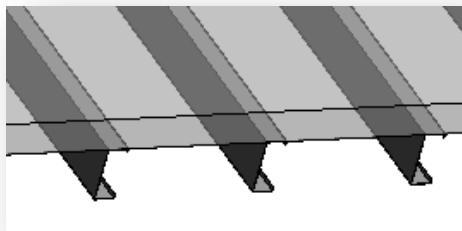

Change View Settings

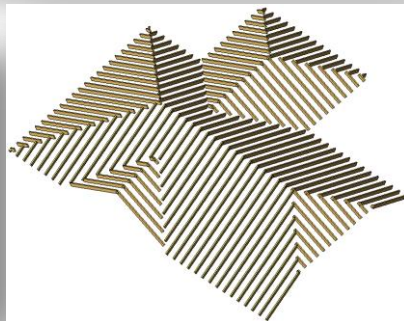
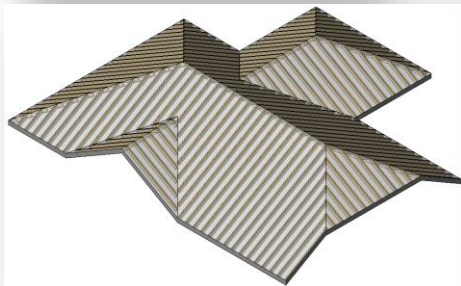
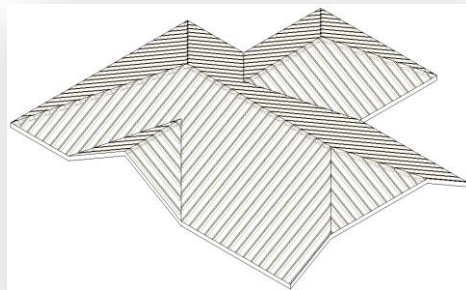
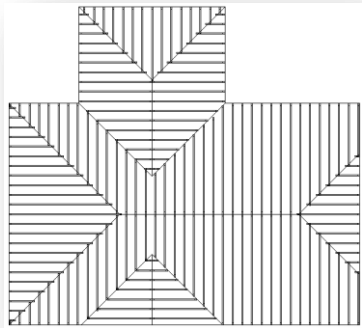

- Choose Detail Level and Model graphics style which best fits your requirements.
- You can make a roof material transparent for the best view and easier work with roof and rafters.
- Now it is the best time to edit distribution of rafters in all slopes.

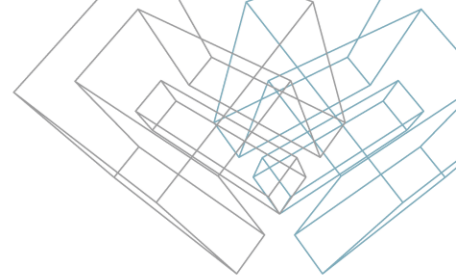

Edit Distribution of Rafters

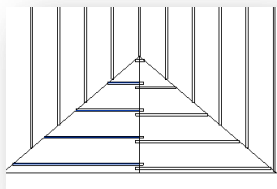

Beginning

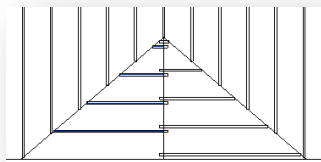

End

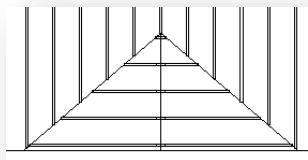

Center

- Select Rafter systems
- Select Justification option
 - Beginning
 - End
 - Center (default)
 - Direction line



Edit Distribution of Rafters

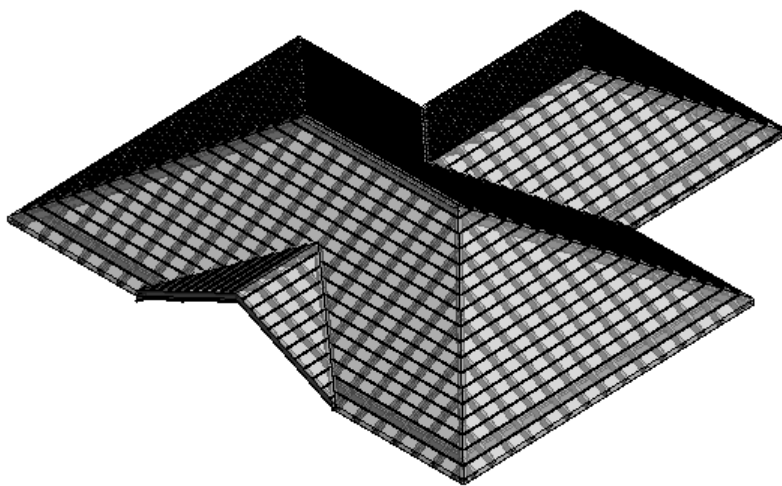
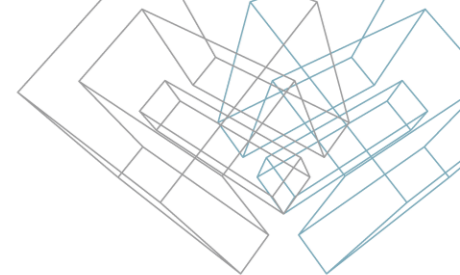

- You can define a precise distance between rafters and the slope side using the **Split Beam System** function of Rafter+M.
- To avoid mistakes and improve performance it is recommended to use this function only after the framing of the roof is finished.

For more information please see the document about the **Split Beam System** function.

Edit Rafter Systems

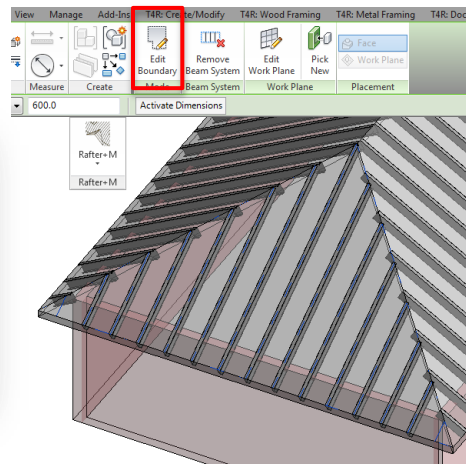
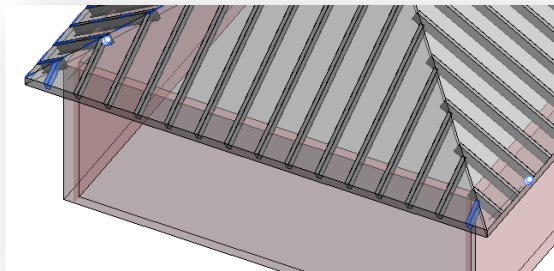
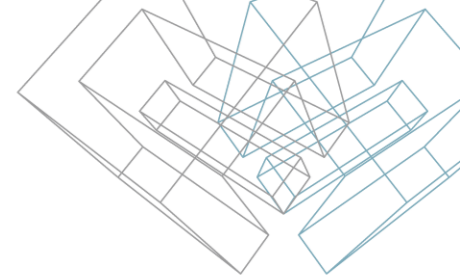

- Select a rafter you want to delete, unpin it and press the Delete button.
- You can easily recover deleted elements of rafter systems:
 - Select Rafter systems;
 - In the ribbon click the **Edit Boundary** tool;
 - Click **Reset System** and then **Finish Beam System**.



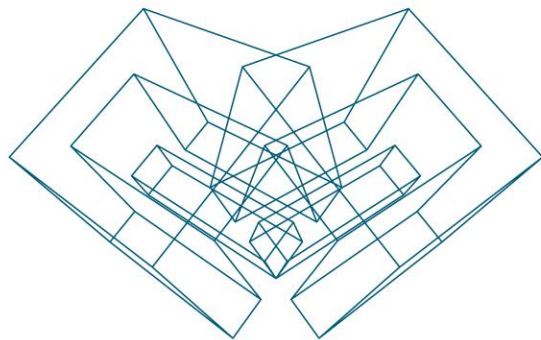

AGA CAD Ltd

T: +370 618 55671 | E: support@aga-cad.com | W: www.aga-cad.com