

An abstract graphic composed of several overlapping, translucent blue and white geometric shapes, including cubes and wireframe boxes, arranged in a dynamic, non-linear fashion. The shapes are semi-transparent, allowing the background and each other to be seen through them.

WOOD FRAMING RAFTER+ Insert/Update Ridge Beams

Insert Ridge Beams

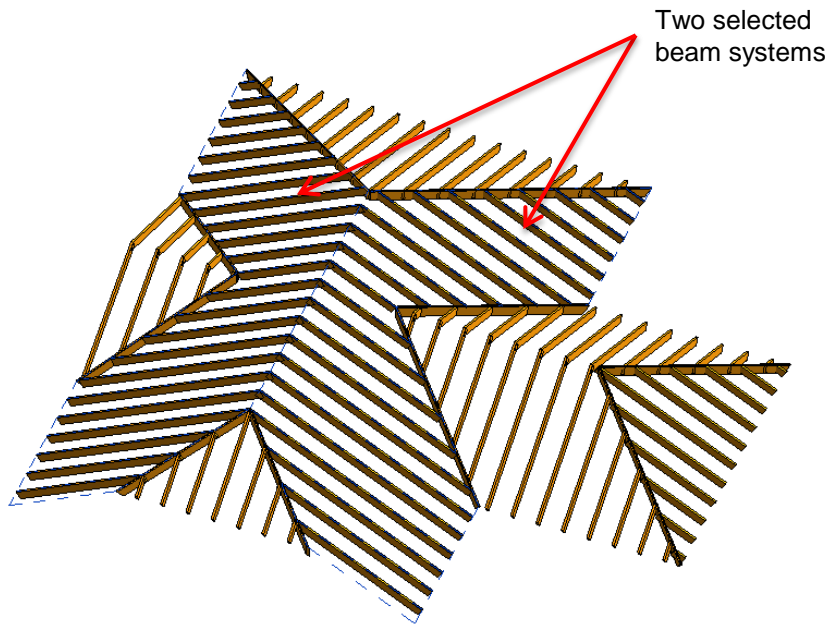

- Select two Rafter Systems in adjacent slopes.
- Select Insert/Update Ridge function from the menu.

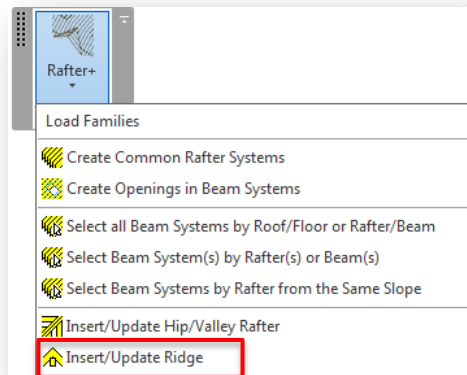

Configure Ridge

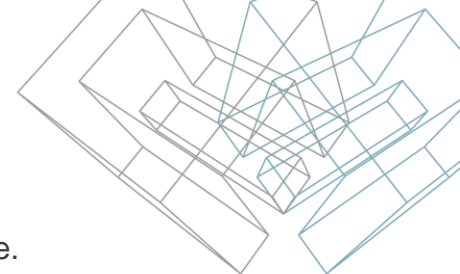

1 Ridge vertical positioning

Left Right

End cut End cut

h cut h cut

2 Ridge horizontal positioning

☐ Offseted

☒ Centered

3 Dimensions

Width (b) 100.00

Depth (h, d) 250.00

Z-Direction offset

Calculated z-Direction offset -259.81

Source ridge

Source ridge beam not selected

Pick source ridge

4 Beam type: M_Rafter_Ridge Beam : 100x250

5 Rafter

☒ Read data from model

☐ Modify rafters

	Left rafter	Right rafter
Width (b)	50.00	50.00
Depth (h, d)	200.00	200.00
Slope angle	30.000	30.000
h cut	0.00	0.00
Calculated h cut	0.00	0.00
Seat cut	0.00	0.00
End cut	50.00	50.00

6 Start hip/valley rafters

☒ Read data from model

☐ Modify rafters

	Left hip	Right hip
Width (b)	50.00	50.00
Depth (h, d)	250.00	250.00
Slope angle	22.208	22.208
h cut	45.64	45.64
Seat cut	120.75	120.75
End cut	50.00	50.00

7 End hip/valley rafters

☒ Read data from model

☐ Modify rafters

	Left hip	Right hip
Width (b)	50.00	50.00
Depth (h, d)	250.00	250.00
Slope angle	22.208	22.208
h cut	45.64	45.64
Seat cut	120.75	120.75
End cut	50.00	50.00

OK Cancel

1. Select vertical positioning type.
2. Select horizontal positioning.
3. Select Ridge beam type from framing families loaded in the project.
4. You can modify Left and Right slope rafters, hip/valley rafters in here, just select the Modify rafters option and make your changes to rafter dimensions.
5. Information about rafters (calculated depth) and Ridge dimensions and offset.
6. Click Pick source ridge to inherit properties from other ridge in model (optional).
7. Click OK to create the ridge.

NOTE: some options vary depending on Ridge's vertical positioning type.

Configure Ridge (horizontal positioning)

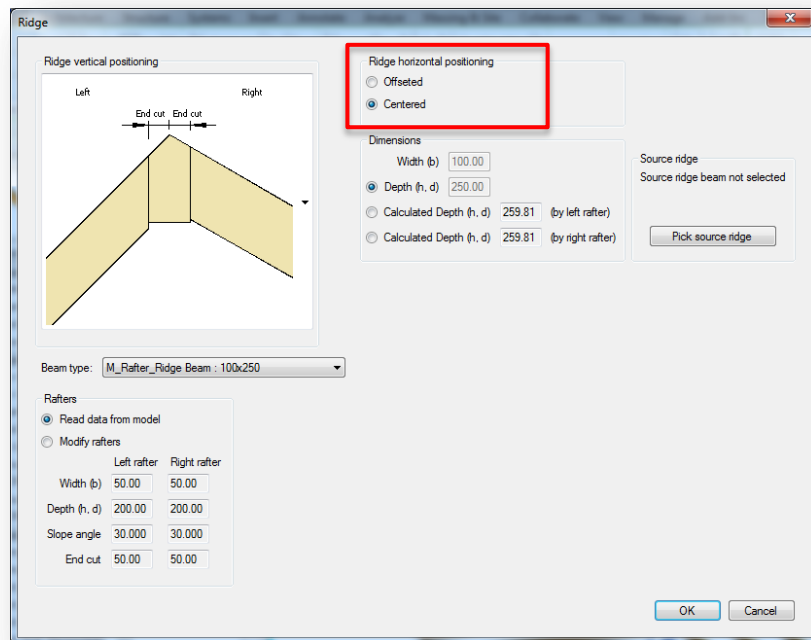
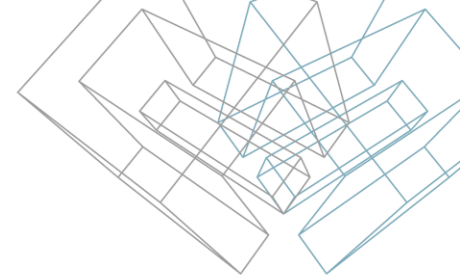

- Select horizontal positioning of the ridge. If the slopes of the roof are asymmetric, then the user should choose desirable positioning: Offseted or Centered.
- If the horizontal positioning is Offseted, the Calculated h (d) is the same on both sides, if it's Centered – h (d) can be different according to slope angles.

Configure Ridge (vertical positioning Type 1)

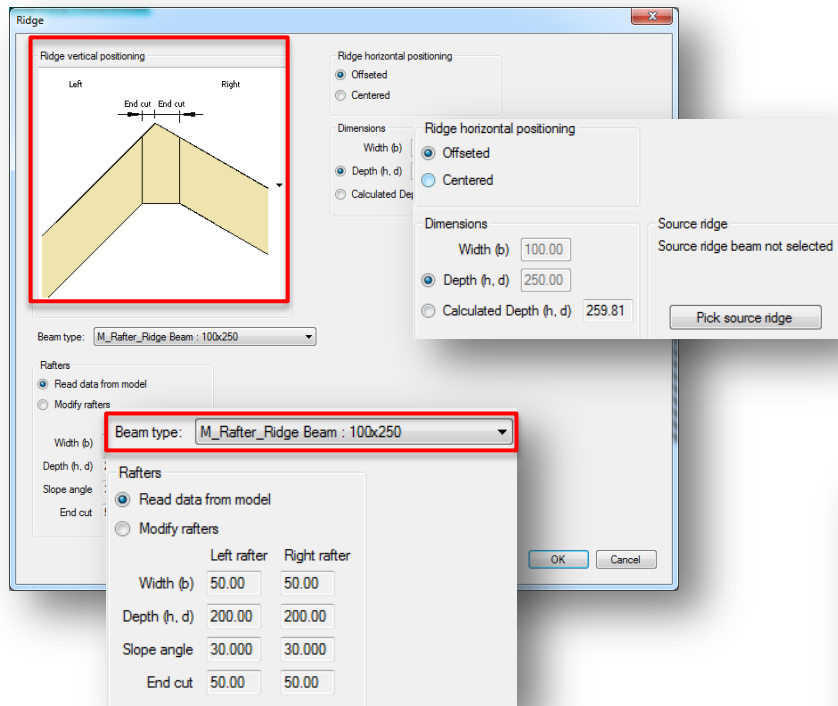
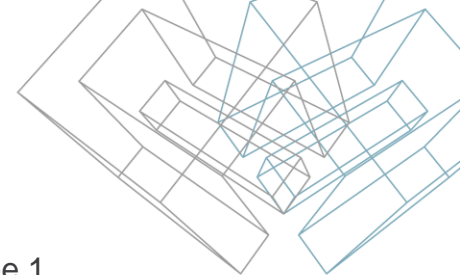

- Select vertical positioning Type 1.
- Select horizontal positioning.
- Select Ridge beam type from framing families loaded in the project.
- You can modify Left and Right slope rafters, just select the Modify rafters option and make your changes to rafter dimensions.
- Click OK to create the ridge.

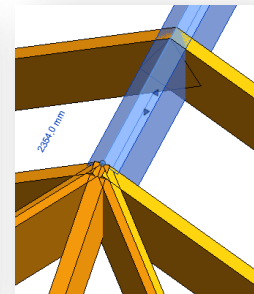
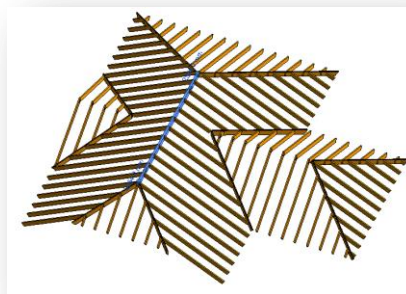

Configure Ridge (vertical positioning Type 2)

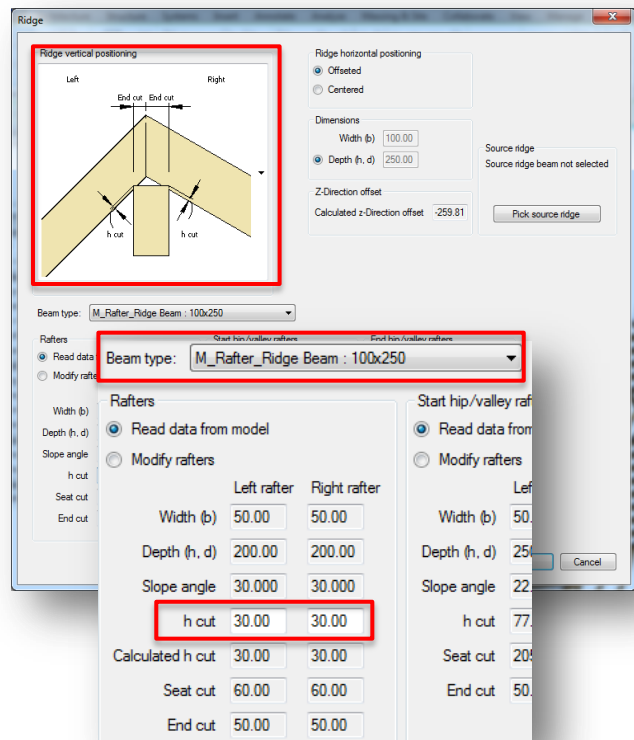
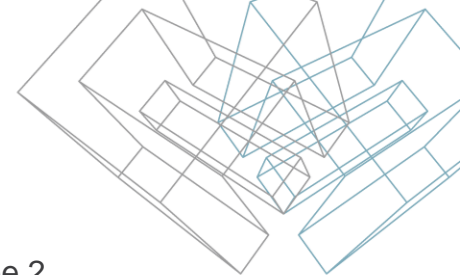

- Select vertical positioning Type 2.
- Select horizontal positioning.
- Select Ridge beam type from framing families loaded in the project.
- Click Pick source ridge to inherit properties from other ridge in the model (optional).
- Calculated z-Direction offset indicates a distance from rafters top to the top of the ridge.
- Provide the h cut dimension of rafters.

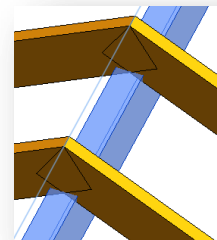

Configure Ridge (vertical positioning Type 2)

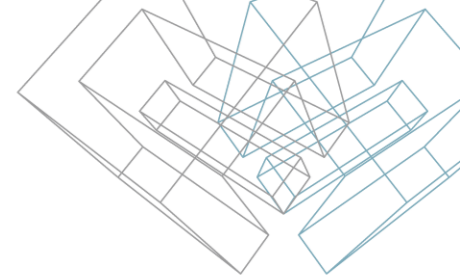

Ridge

Ridge vertical positioning

Left Right

End cut End cut

h cut h cut

Ridge horizontal positioning

☒ Offseted
☐ Centered

Dimensions

Width (b) 100.00

Depth (h, d) 250.00

Source ridge
Source ridge beam not selected

Z-Direction offset

Calculated z-Direction offset -259.81

Pick source ridge

Beam type: M_Rafter_Ridge Beam : 100x250

Rafters

☒ Read data from model
☐ Modify rafters

Left rafter Right rafter

Width (b) 50.00 50.00

Depth (h, d) 200.00 200.00

Slope angle 30.000 30.000

h cut 30 30

Seat cut 0.00 0.00

End cut 50.00 50.00

Beam type: M_Rafter_Ridge Beam : 100x250

Rafters

☒ Read data from model
☐ Modify rafters

Left rafter Right rafter

Width (b) 50.00 50.00

Depth (h, d) 200.00 200.00

Slope angle 30.000 30.000

h cut 30.00 30.00

Calculated h cut 30.00 30.00

Seat cut 60.00 60.00

End cut 50.00 50.00

Start hip/valley rafters

☒ Read data from model
☐ Modify rafters

Left hip Right hip

Width (b) 50.00 50.00

Depth (h, d) 250.00 250.00

Slope angle 22.208 22.208

h cut 77.71 77.71

Seat cut 205.60 205.60

End cut 50.00 50.00

- You can see calculated h cut for hip/valley rafters and make a decision whether to modify them or not.

Select the Modify rafters option and make your changes to hip/valley dimensions b and h. Leave the option Read data from model active if you don't want any changes in hip/valley.

- Click OK to create Ridge.

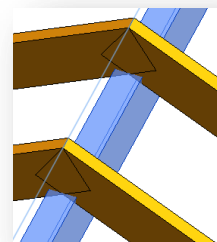

Configure Ridge (vertical positioning Type 3)

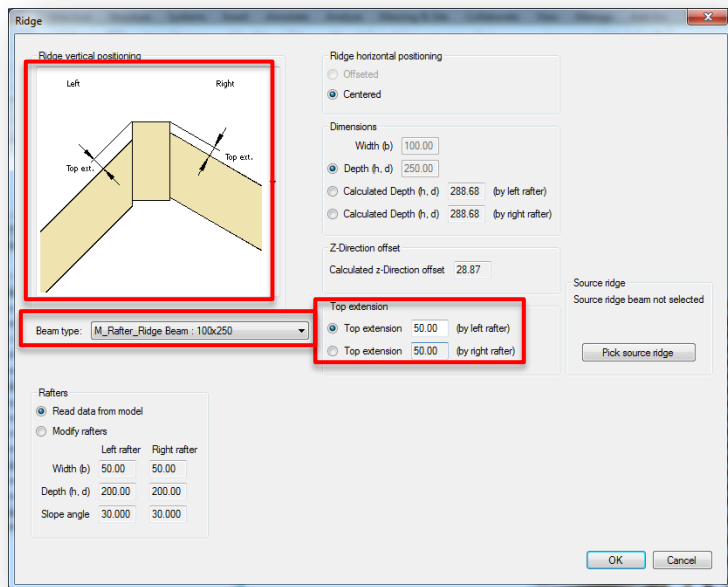
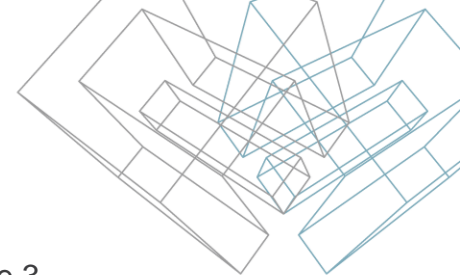

- Select vertical positioning Type 3.
- Select Ridge beam type from framing families loaded in the project.
- Click Pick source ridge to inherit properties from other ridge in the model (optional).
- Enter Top extension value depending on the left or the right rafter.
- Click OK to create Ridge.

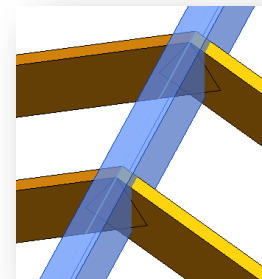

Configure Ridge (vertical positioning Type 4)

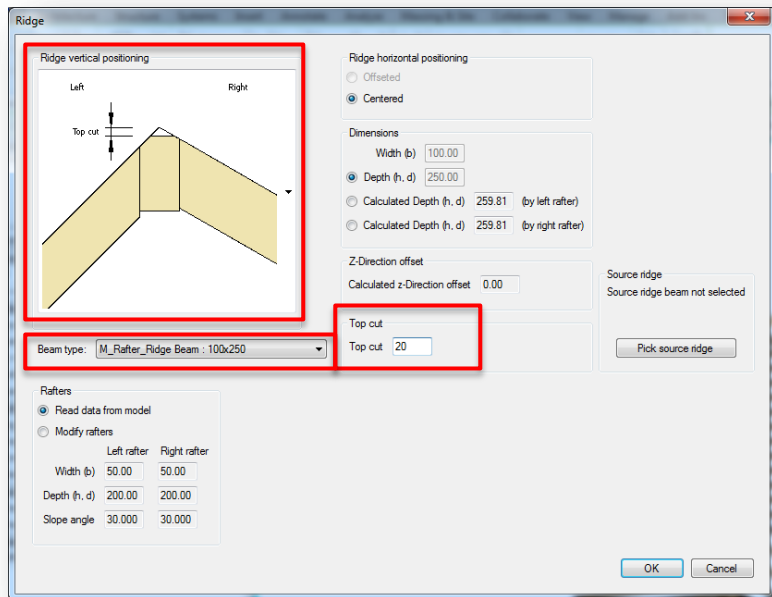

- Select vertical positioning Type 4.
- Select Ridge beam type from framing families loaded in the project.
- Click Pick source ridge to inherit properties from other ridge in the model (optional).
- Enter Top cut value.
- Click OK to create Ridge.

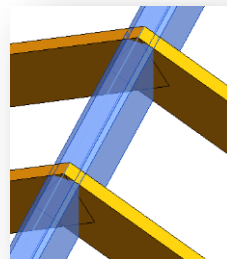

Update Existing Ridge

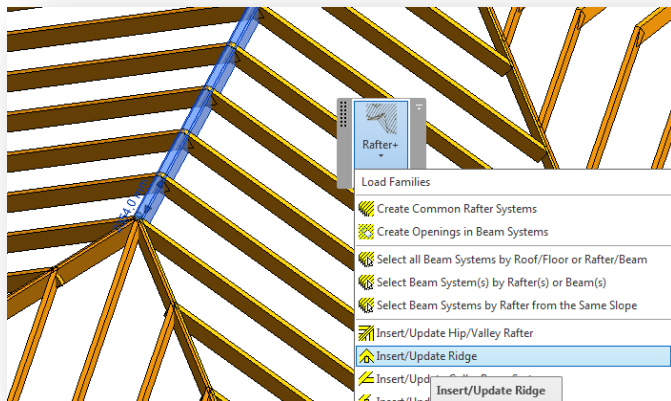

- Select a ridge you want to update.
- Select the Insert/Update Ridge function from the menu.
- Select Ridge's vertical positioning type.
- Make your changes to dimensions of the ridge.
- If required, modify dimensions of rafters, and click OK.

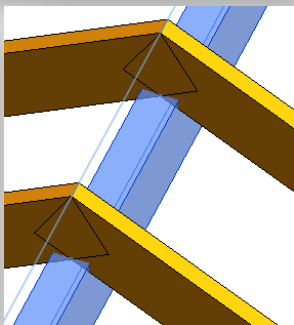
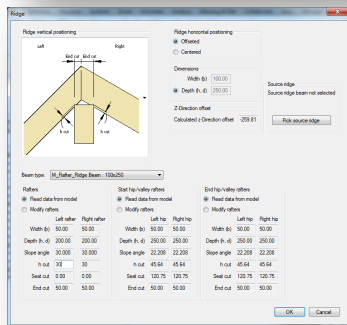

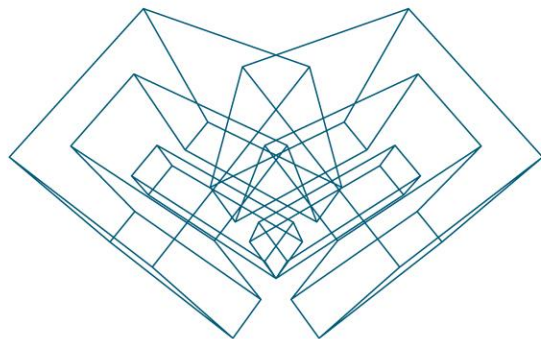

AGA CAD Ltd

T: +370 618 55671 | E: support@aga-cad.com | W: www.aga-cad.com