

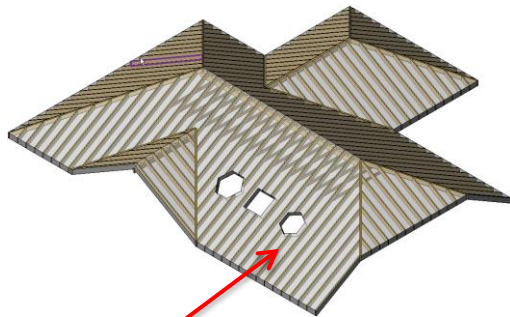

WOOD FRAMING RAFTER+ Frame Openings (by Face)

Frame Openings (by Face)



Selected beam system with three openings.

Note that framing elements perpendicularly to rafters, automatically extends elements to the nearest rafter beam.

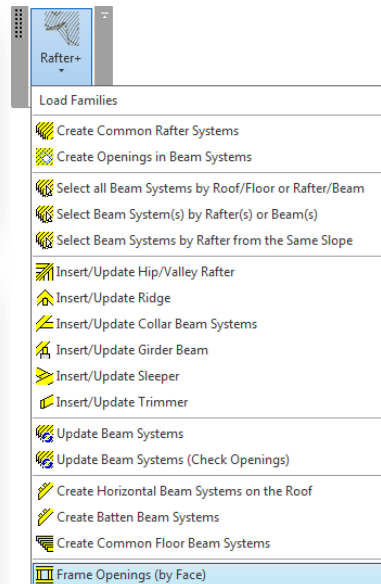
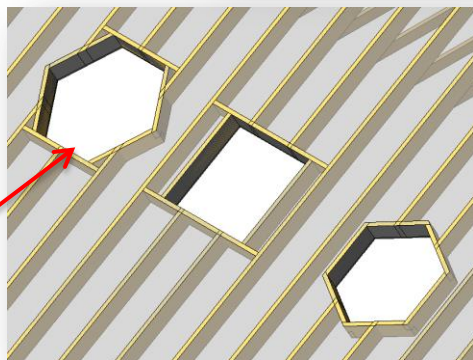
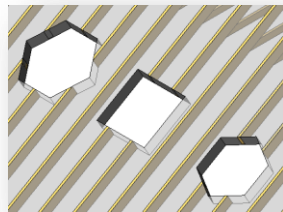

- Select single, multiple or all instances of beam systems.
- Select the **Frame Openings (by Face)** function from the menu.

Update Joints and Cuts of Framed Openings

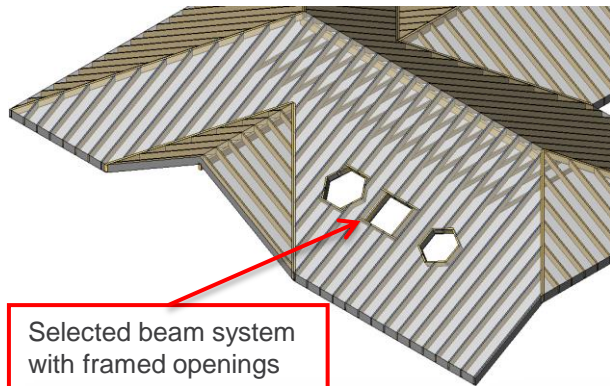
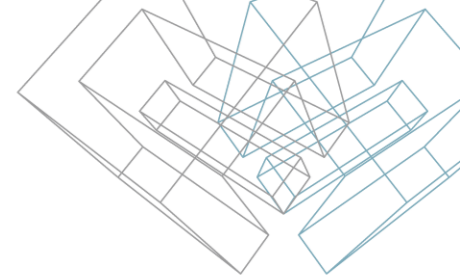

- Select single, multiple or all instances of beam systems.
- Select the **Update Beam Systems** function from the menu.

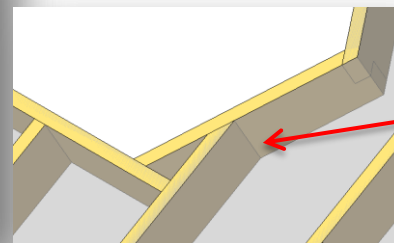
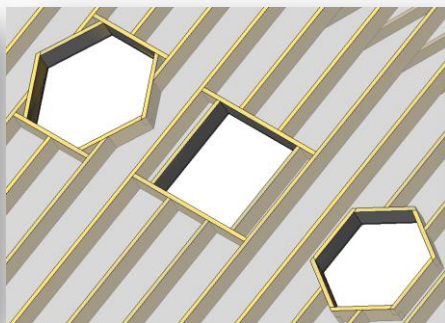
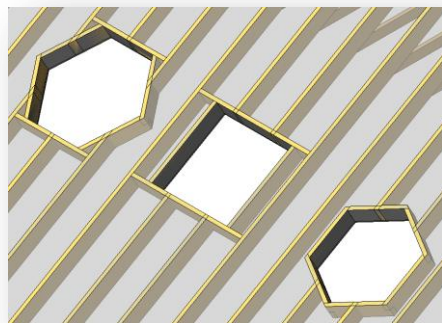

Update framing joints and end cuts

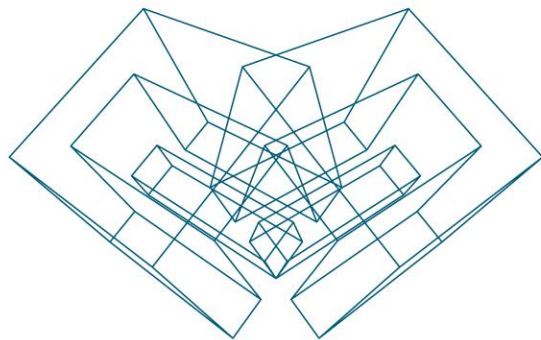

AGA CAD Ltd

T: +370 618 55671 | E: support@aga-cad.com | W: www.aga-cad.com